

VALVE ADAPTERS AND MANIFOLDS

for memetis microvalves

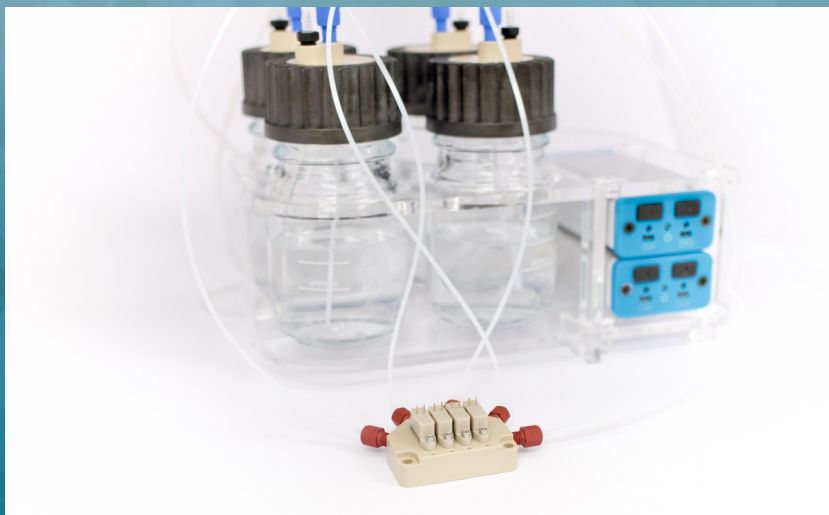

memetis fluidic adapters allow for quick implementation and testing of single valves as well as a number of standard valve configurations. Having a flange-mount interface for memetis microvalves, the adapters are available with different fluidic fittings. Our selection of milled PEEK adapters provides the perfect solution for testing different fluidic circuits, offering superior thermo-mechanical properties and chemical stability for the success of your microfluidic experiment!

Choose Your Functionality

Thanks to their flange mount interface, memetis valves offer an extremely compact form factor for integration on a fluidic backplane. If you prefer connecting the valves by tubing, you can choose from a wide selection of memetis valve adapters - ranging from single-valve adapters to functional modules for channel distribution and channel merging. For more complex functional solutions and custom fluidic backplanes simply give us a call!

Choose Your Fitting Interface

Our adapters are available with 10-32 UNF internal threads. Optionally, you can order the adapters with 3rd-party standard fluidic fittings from Luer or IDEX already pre-installed. As an alternative, we offer selected adapters also with nozzles for direct tube fitting.

2/2-Way Valve Adapters with Direct Tubing

SINGLE VALVE ADAPTER AD-MVL22-PEEK-1v-B16

Add tube connectors to a single memetis valve.

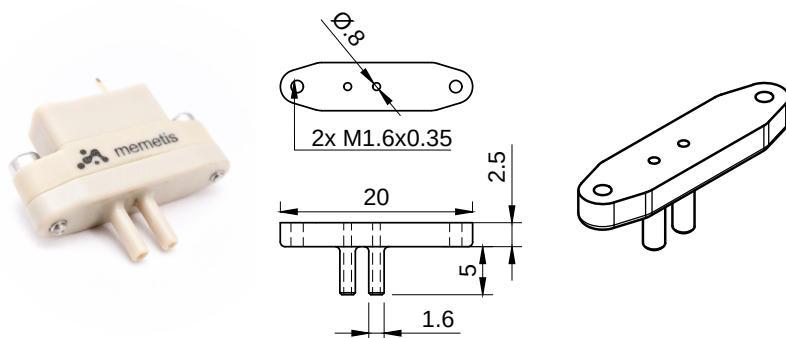

Assembly Instruction

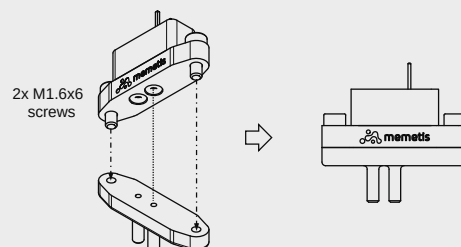

TWO-VALVE ARRAYS AD-MVL22-PEEK-2v-B16

Combine two memetis 2/2-way valves to emulate a 3/2-way valve with tube connectors.

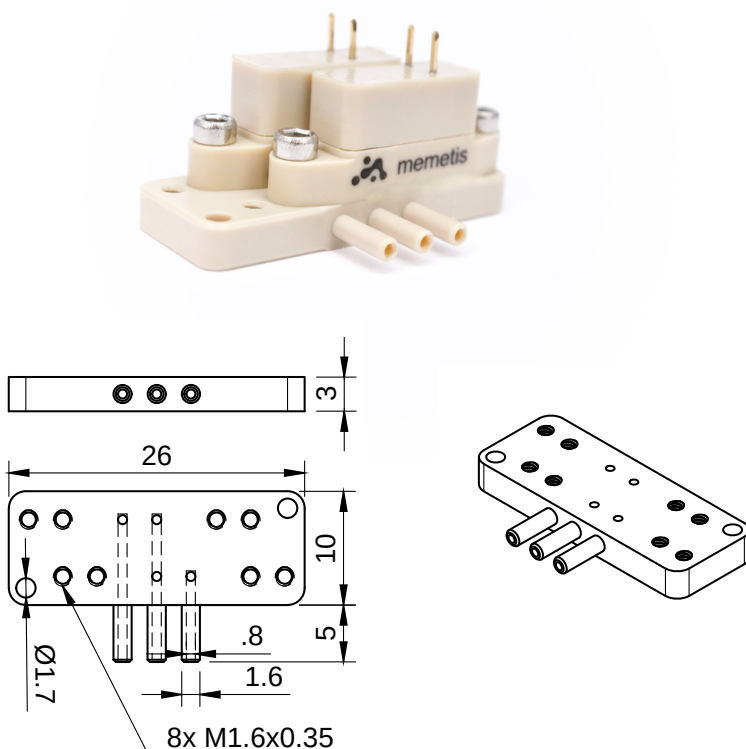

Assembly Instruction

Configuration 1 -
Fluid Distribution

Configuration 2 -
Fluid Mixing

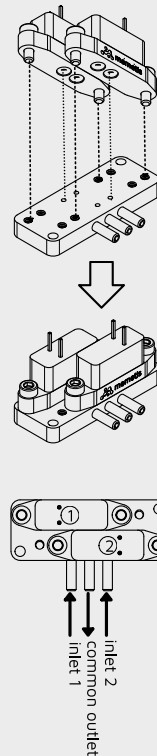
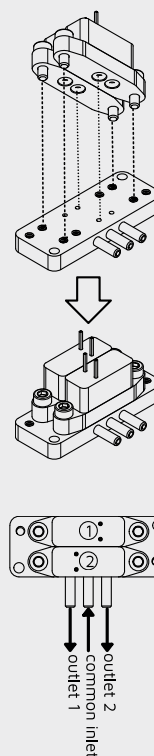

Contact

memetis GmbH, Gablonzer Str. 27, 76185 Karlsruhe, Germany
Tel. +49 721 47000240, Email sales@memetis.com

2/2-Way Valve Adapters with Internal Threadings

SINGLE VALVE ADAPTER AD-MVL22-PEEK-1v-T1032

Connect a single memetis valve to your preferred 3rd-party tube fitting.

Luer Option



IDEX Option

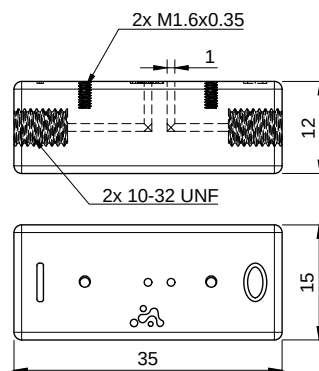

Without Fitting

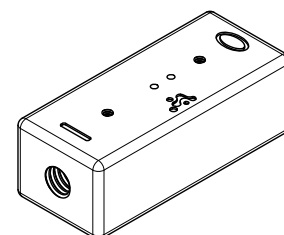

TWO-VALVE ARRAY AD-MVL22-PEEK-2v-T1032

Emulate the functionality of a 3/2-way valve: choose between two input fluids with the „Fluid Mixing“ configuration or direct fluids to one of two target containers using the „Fluid Distribution“ configuration.

Luer Option



IDEX Option

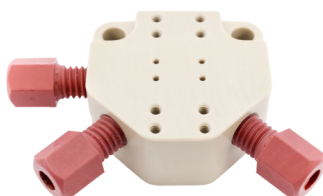

Without Fitting

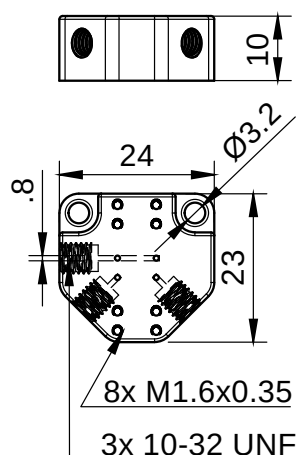
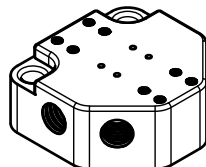

Configuration 1 -
Fluid Distribution

Configuration 2 -
Fluid Mixing

Assembly Instruction

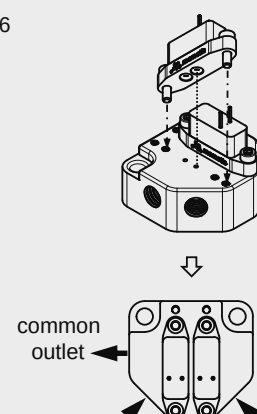
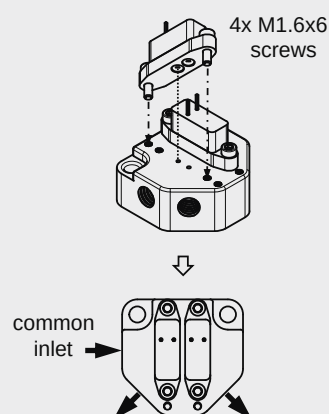

FOUR-VALVE ARRAY AD-MVL22-PEEK-4v-T1032

Connect four input reservoirs to your application with the „Fluid Mixing“ configuration or direct fluids into four target channels using the „Fluid Distribution“ configuration.

Luer Option



IDEX Option

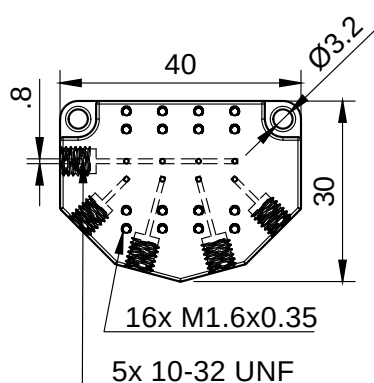
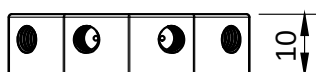

Without Fitting

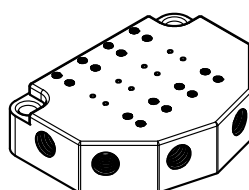

Configuration 1 -
Fluid Distribution

Configuration 2 -
Fluid Mixing

Assembly Instruction

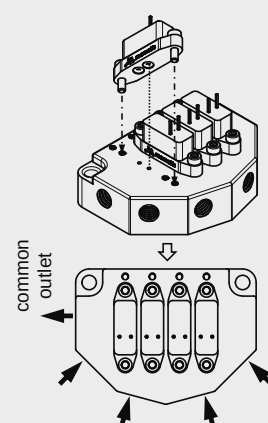
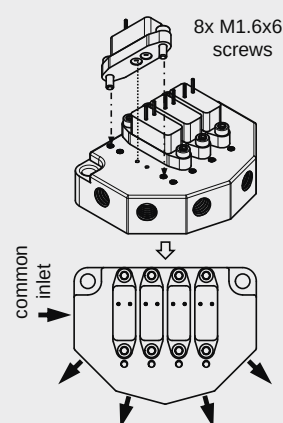

Quick & For Free

You have memetis valves in stock but forgot to order adapters for quick testing? Then just follow this [link](#) to our website to download STL files for various adapter configurations. With your favorite 3D printer and resin, you can assemble your fluidics setup in no time. Just download and print the STL models and start testing now!



Contact

memetis GmbH, Gablonzer Str. 27, 76185 Karlsruhe, Germany
Tel. +49 721 47000240, Email sales@memetis.com

Valve Adapters and Manifolds - Ordering Codes

AD-MVL22-PEEK-1v-T1032-L
 Adapter Valve Model Material Valve Amount Interface 3rd-Party Fitting (optional)

Parameter	Value	Description
Valve Model	MVL22	2/2-Way normally-closed microvalve line / bistable microvalve line
Material	PEEK	Polyetheretherketone (milled)
Valve Amount	1v 2v 4v	Single Valve Adapter Two-Valve Array Four-Valve Array
Interface	T1032 B16	10-32 UNF thread Tube connector for soft tubes (e.g. silicone, with ID 1 - 1.6mm)
3rd-Party Fitting	L I-OD16	Male Luer fitting IDEX flangeless fitting for rigid tubes (e.g. PTFE, with outer diameter 1.6mm (1/16"))

Contact

memetis GmbH, Gablonzer Str. 27, 76185 Karlsruhe, Germany
 Tel. +49 721 47000240, Email sales@memetis.com